

# TOSHIBA

Leading Innovation >>>

## TRST-A10 Thermal Printer

New Generation High-Speed Thermal Printer



- High Speed Printing – Up to 225mm/sec
- 2-Colour Thermal Printing
- Superb Paper Handling
- Low maintenance



## TOSHIBA TRST-A10

### Ultra High Speed Printing

The TRST-A10 is one of the fastest thermal printers in its class. The new development in print head technology has greatly improved the printing speed to 225mm/sec. There is no need to keep customer waiting anymore with the new TRST-A10.

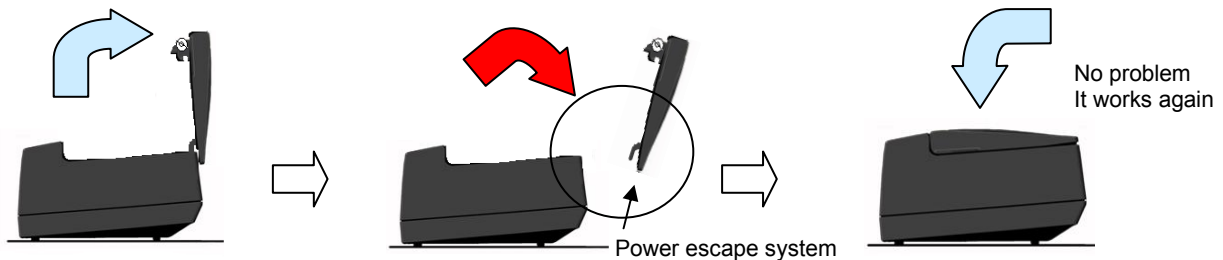

### Power Escape System

The TRST-A10 has a robust design for any harsh retail environment. It features a power escape system where the hinge to the top cover is designed to come off without damaging the print-head and the printer is able to continue operating once the cover is replaced.

### Easy Operation

The printer comes with the standard drop-in paper loading and standard auto-cutter, making it extremely easy to use and maintain.

### Selectable Paper Width

The TRST-A10 allows you to print on 2 types of paper – 80mm / 58mm without having to change your printer. By adding in a paper guide (optional), the printer is able to print from a 80mm to a 58mm roll paper with ease.

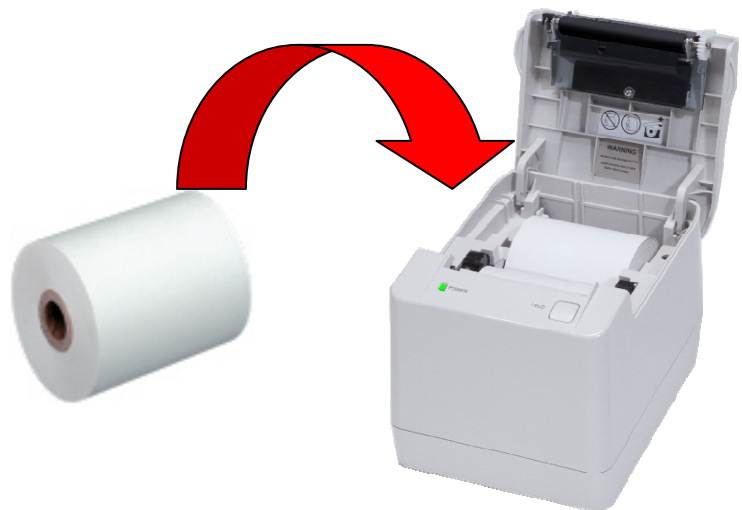

Model Name	<b>TRST-A 10</b>
Paper Width	80mm +0.5/-15mm /58mm +0.0/-10mm (Receipt guide for 58mm width paper is option)
Paper loading method	Drop in paper loading
Auto Cut	Partial cut (2mm uncut at right side)
Interface	Serial & USB 2.0 (Parallel : Option)
Drawer kick port	1
Printing method	Line thermal printing (Direct thermal method)
Printing speed	Max. 225mm/sec for 1color printing Max. 75mm/sec (2 colors printing)
Printing columns	12 x 24 dots : 48 columns (80mm) 9 x 24 dots : 64 columns (80mm) 12 x 24 dots : 36 columns (58mm) 9 x 24 dots : 48 columns (58mm)
Character size	12 x 24 dots : 1.25x3.00mm 9 x 24 dots : 0.88x3.00mm
Character types	PC437, PC652, PC850, PC857, PC858, PC860, PC863, PC865, PC866, PC1252
Printable barcode	UPC-A/E, JAN(EAN)13/8, Code39, Code128, Interleaf 2 of 5, CODABAR, PDF417, Code93
Line spacing	8.47, 8.13, 7.81, 7.25, 7.00, 5.98, 7.52(default) and variable line per inch
Paper	Roll paper diameter : 80mm or less Basic weight : 55g/m <sup>2</sup> Standard paper thickness : 0.062mm Smoothness : 180sec. Min.
Paper near end sensor	Yes Paper exhaust sensor Paper low sensing : 15 feet (Adjustable by user)
Power consumption	55W mode/ 75W mode
Weight	16kg
Dimension	145.5mm(W) x 185.0mm(D) x 138.5mm(H)

Specifications are subject to change without notice

**TOSHIBA TEC AUSTRALIA PTY LTD**

Unit 1, 9-11 South Street, Rydalmere, NSW 2116

Phone: (02) 8845 6211, Fax: (02) 9680 0892

Web: [www.toshibatec.com.au](http://www.toshibatec.com.au)